

120/120 Plus Digital Weight Indicator

APPROVALS

Measurement
Canada
Approved

SPECIFICATIONS

Power:**120/120 Plus:**

Line voltages: 115 or 230VAC

Frequency: 50 or 60 Hz

120 Plus: (estimated battery life)60 hours with 1 x 350 Ω 40 hours with 4 x 350 Ω

Charge time 8 hours

Excitation Voltage:5VDC, 4 x 350 Ω or 8 x 700 Ω load cells**Analog Signal Input Range:**

-0.6 mV/V - 3.0 mV/V

Analog Signal Sensitivity:0.3 μ V/graduation minimum,1.5 μ V/grad recommended**Resolution:**

Internal resolution:

1 million internal graduations

Display resolution:

10,000 displayed graduations

Measurement Rate:**120:** 30, 15, 7, 3 per second**120 Plus:** 30 per second**System Linearity:**

Within 0.01% of full scale

Circuit Protection:

RFI, EMI, ESD protected

Load Cell Connection:

Cord grip entry

Detachable plug (optional)

Serial Output:

EDP port: Full duplex RS-232

Printer port: Output-only RS-232 or active 20 mA current loop

Both ports: 9600, 4800, 2400, 1200, 600, 300 bps; 7 or 8 data bits; even, odd or no parity

Display:**120:**

0.8 in (20 mm), 6-digit Red Light Emitting Diode (LED) display, 7-segment digits

120 Plus:0.8 in (20 mm) 6-digit LCD with backlight
7-segment digits**Status Annunciators:**

Designators for: center of zero, stand still, gross, net, lb, kg, oz, g

120 Plus:

Battery, setpoint 1 & 2, Hold

Keyboard:**120:**

5-key flat membrane panel, tactile feel

120 Plus:Zero, tare, present tare, hold, gross/net, units, numeric
0-9, clear, enter/print

- Full front-panel digital calibration and configuration

- Tilt stand
- Three-stage digital filtering
- Consecutive transaction numbering
- Time and date (volatile)

120 Plus

- Large .8 in backlit LCD display
- Rechargeable battery and wall adapter
- Power save feature for 700 hours of battery life
- Ten stored tare values
- Display hold (based on 3 second average)
- Time and date

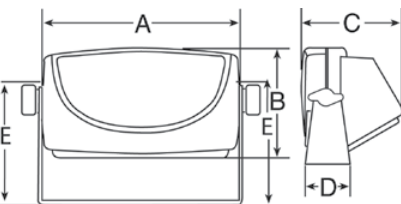

DIMENSIONS

A	7.32 in (1863 mm)	D	1.65 in (42 mm)
B	6.06 in (154 mm)	E	4.76 in (121 mm)
C	3.74 in (95 mm)		

RICE LAKE
WEIGHING SYSTEMS

120/120 Plus Digital Weight Indicator**PART NUMBER/PRICE**

PART #	DESCRIPTION	EST. SHIP WEIGHT	PRICE
120			
131923	Desktop 115VAC/230VAC**	3 lb	Consult
120 Plus			
103632	Desktop 115/230VAC**	3 lb	Consult
107619	Desktop 115/230VAC with digital I/O option**	3 lb	Consult

OPTIONS/ACCESSORIES

PART #	DESCRIPTION	PRICE
93205	Load cell connector with 6 meter length pigtail (requires 103507)	Consult
82505	6-pin socket external load cell connector (requires 103507)	Consult
103507	External load cell plug replaces cord grip (requires 82505 or cable 93205)	Consult
107620	Digital I/O card for 120 Plus	Consult
105670	15 Pin connector for 120 Plus	Consult
106705	15 Pin Interface cable for 120 Plus, 2-meter length	Consult
76699	Additional operating manual for 120	Consult
105914	Additional operating manual for 120 Plus	Consult
77925	Revolution* Scale software*	Consult
Primary Component Parts for 120		
131924	Board assembly for use with internal LC connector	Consult
78610	Overlay membrane switch	Consult
131925	Power supply, 115VAC/230VAC**	Consult
Primary Component Parts for 120 Plus		
103634	CPU/Display board assembly	Consult
103635	Overlay membrane switch	Consult
103636	Power supply, 115VAC/230VAC	Consult
103637	Rechargeable Battery	Consult

* Revolution* can be downloaded for FREE at www.ricelake.com



CEE 7/7 plug



NEMA 5-15 plug

**Both plugs included